

FLEXISPOT

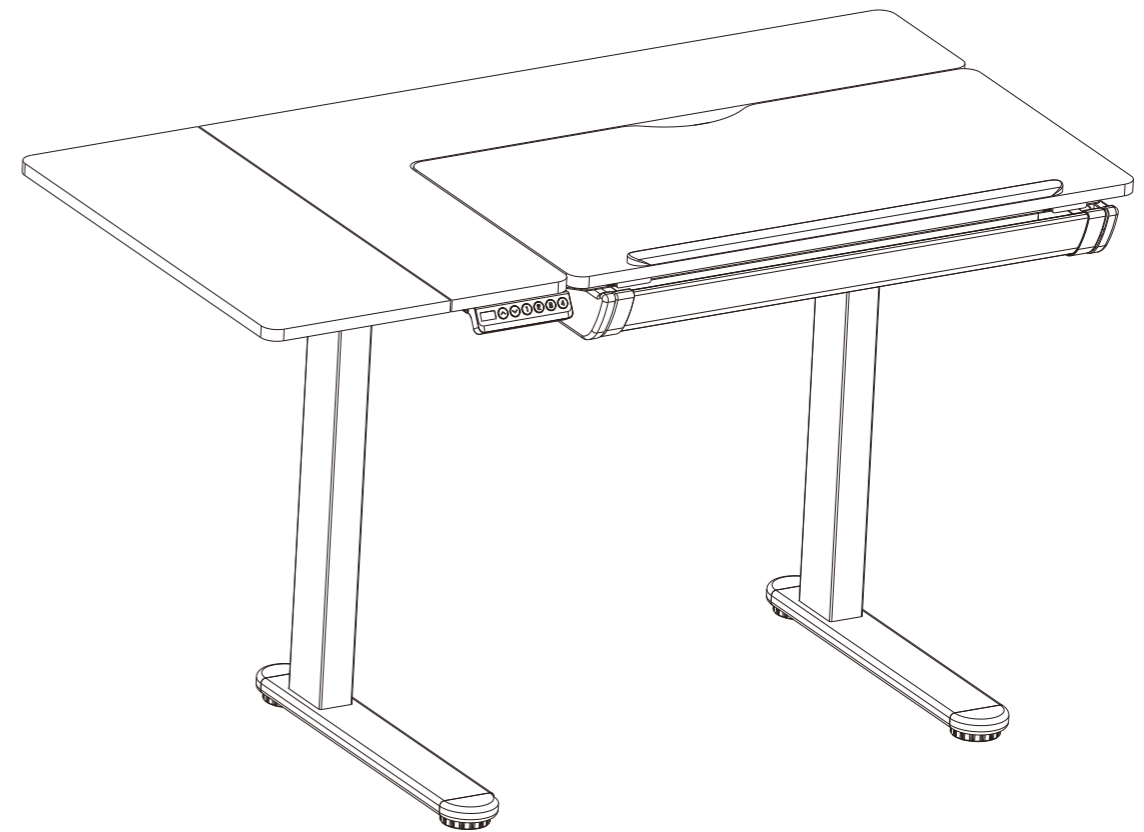

Item No. ET120
Installation Guide

Website: www.flexispot.com
Tel: 1-855-421-2808

Actuator is certified and supplied by Loctek Linear Motion

Specifications

Lifting column type	2 stage
Weight capacity	110 lbs (50kg)
Speed	1"/s
Input voltage	100-240V
Minimum height	28.7" (730mm)
Maximum height	48.4" (1230mm)
Desktop size	37.4"x23.6"(950mm×600mm)
Extension board size	23.6"x9.8" (600mm x 250mm) (11 lbs weight capacity)
Tilt angle	32° - 104° F
Duty cycle	10% (Working 2 minutes then stop 18 minutes)
Operating temperature	32° - 104° F

Accessory Package

Figures shown are for reference only. Please contact customer service if there are any accessory or tools missing.



Parts Included

NO.	Parts	Qty	NO.	Parts	Qty	NO.	Parts	Qty
①	Desktop	1	②	Extension board	1	③	Lifting column	2
④	Desk foot	2	⑤	Support Pad	1	⑥	Handset	1
⑦	Power cord	1	⑧	Power adapter	1	⑨	Cable tie	4
⑩	Adapter cable	1	⑪	Extension cord	1			

Diagram of Components

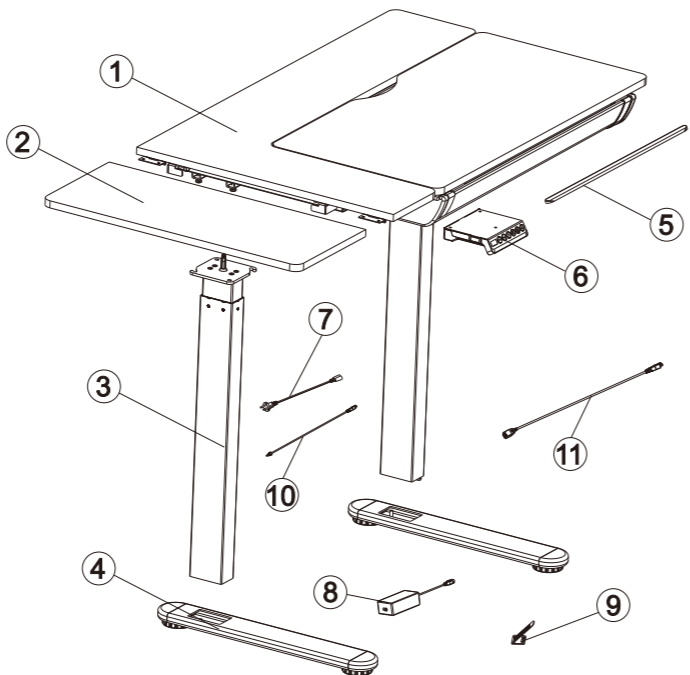

Step 1

Install lifting columns

Rotate column after insertion to avoid uneven column height. The long edge of the column should be parallel to the short edge of the desktop.

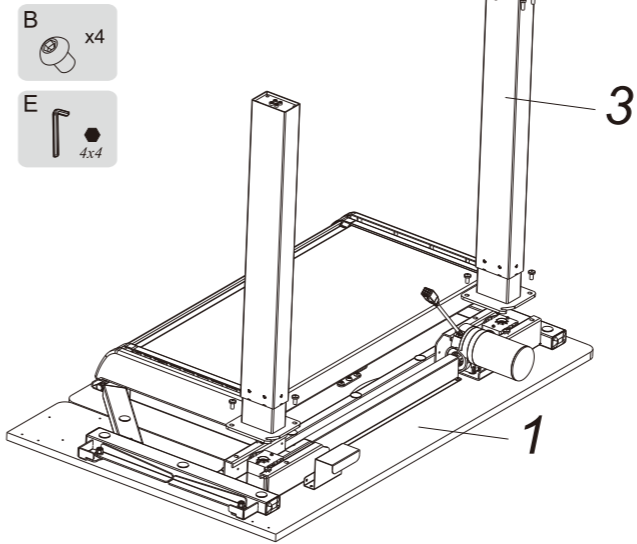

Connect lifting columns (3) to the desktop (1) using screws (B) and wrench (D).

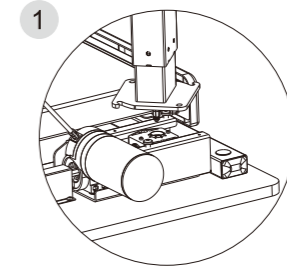

1 Insert the hexagonal post of the lifting column into the corresponding hole in the desktop.

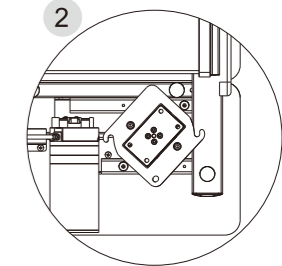

2 Insert the hexagonal post of the lifting column into the corresponding hole in the desktop.

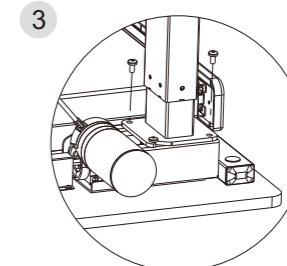

3 Use 4x4 wrench (E) to tighten down screws (B).

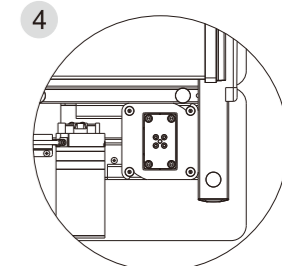

Step 2

Install Desk Feet

Attach table feet (4) to the lifting columns with screws (C) and 4x4 wrench (E).

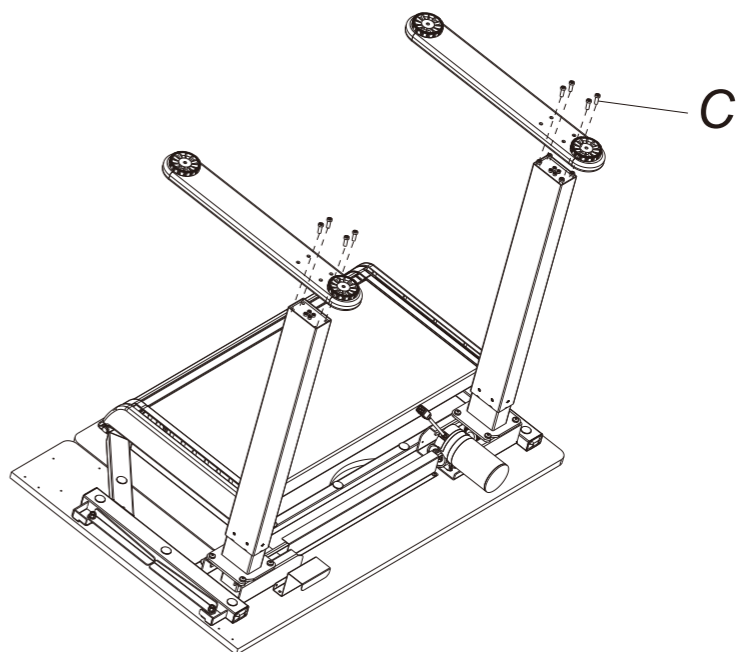
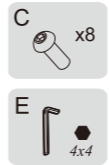

Step 3

Install Adapter and Cables

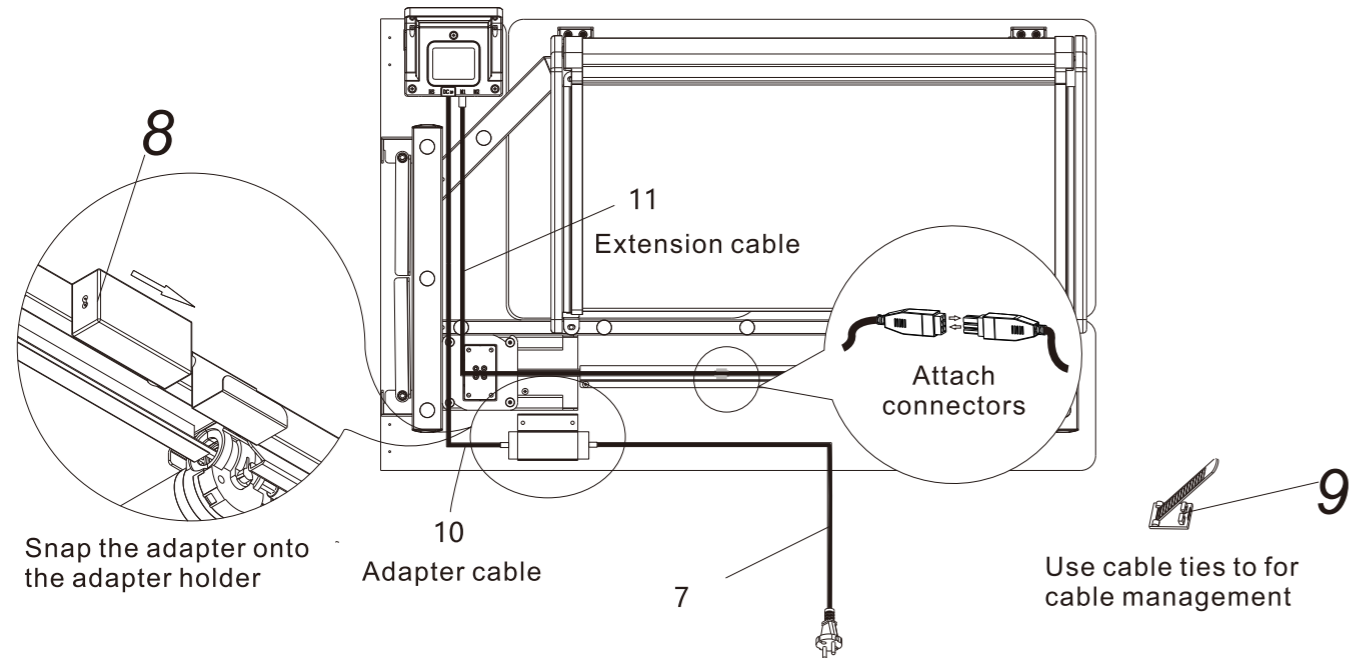

Step 4

Install Handset

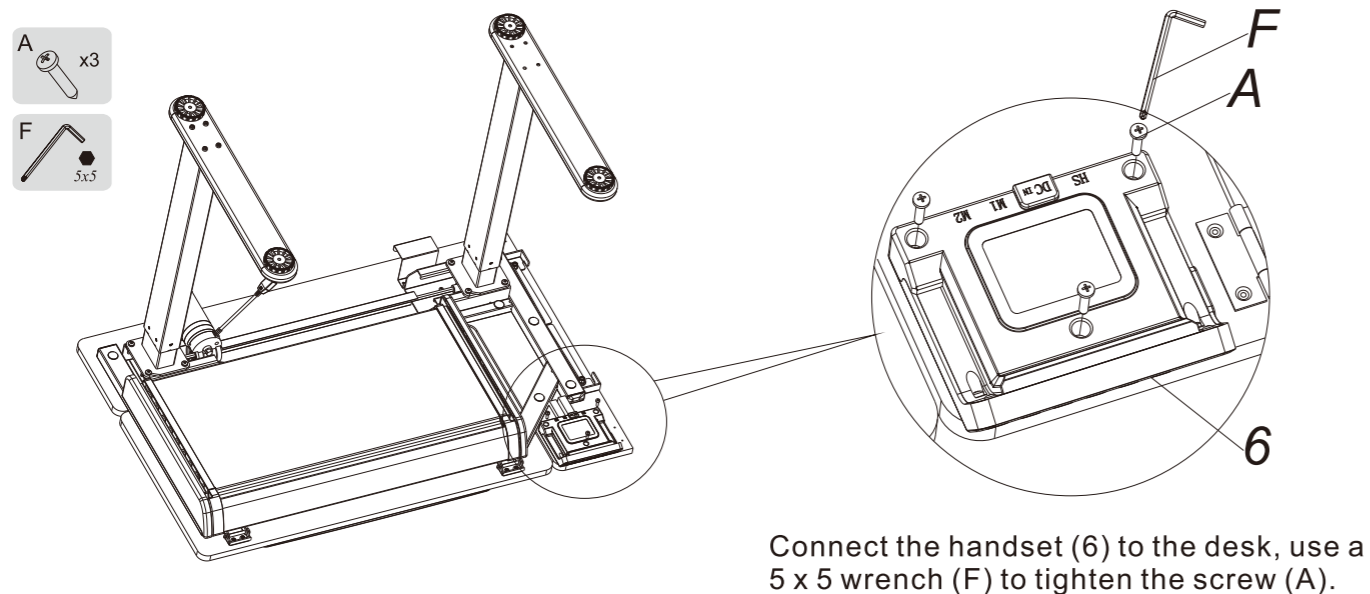

Step 5

Install Extension Board

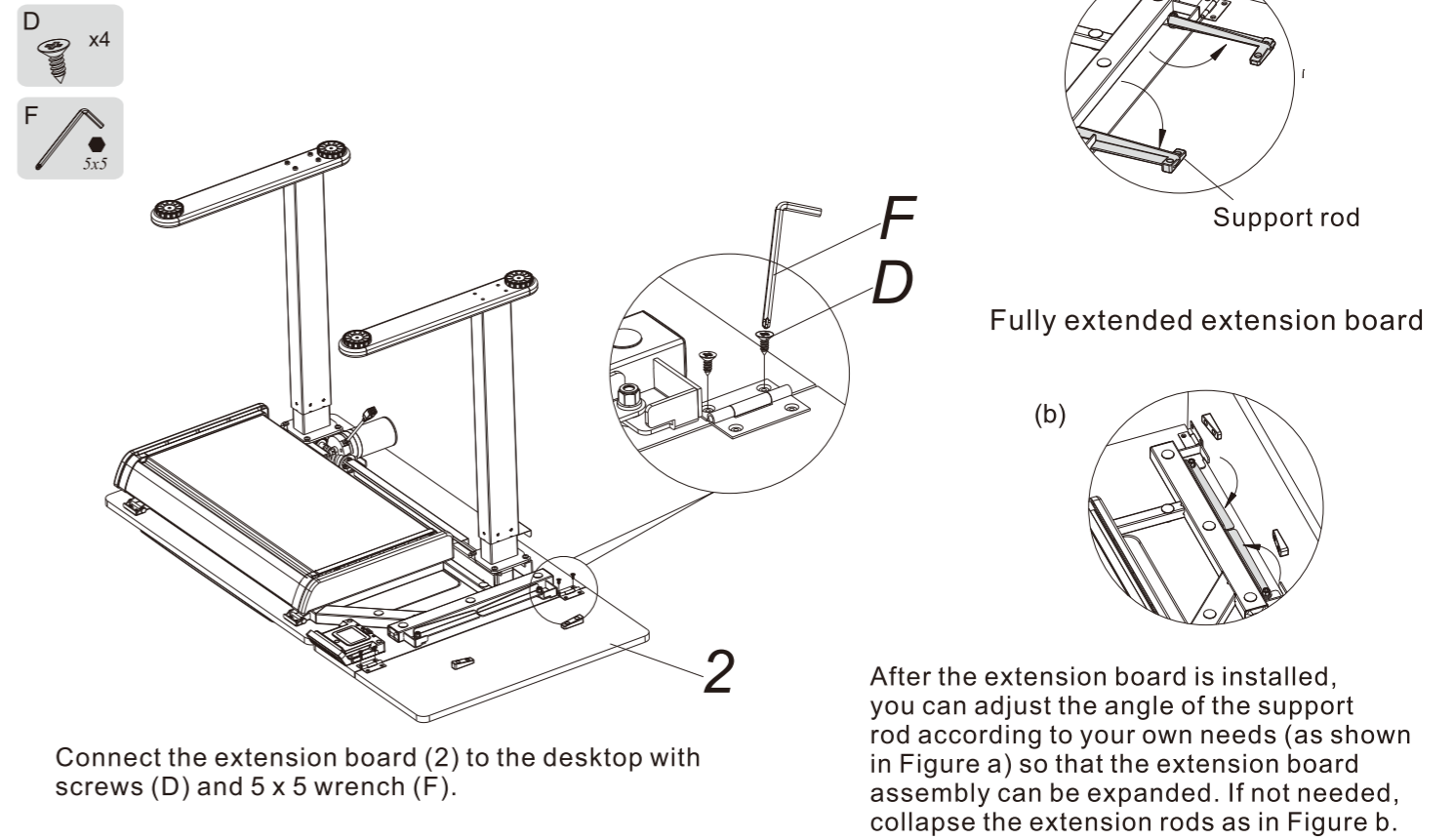

Step 6

Install Support Pad

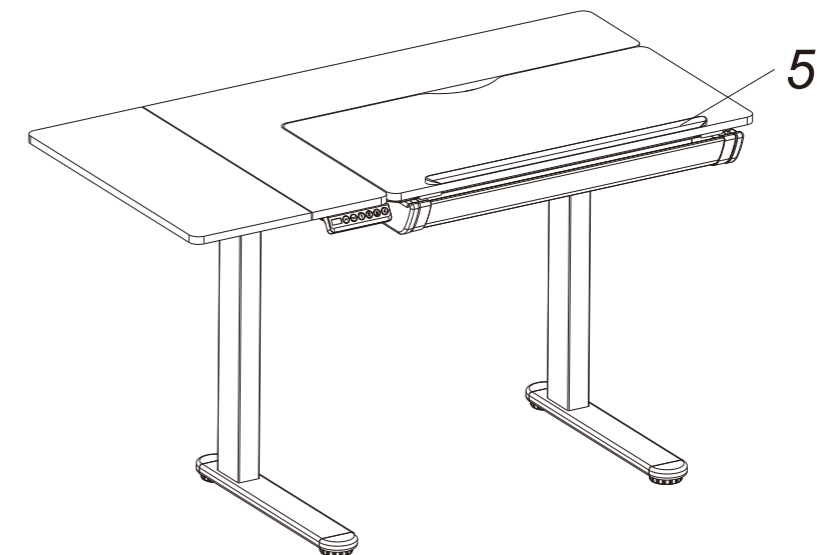

Keypad Instruction

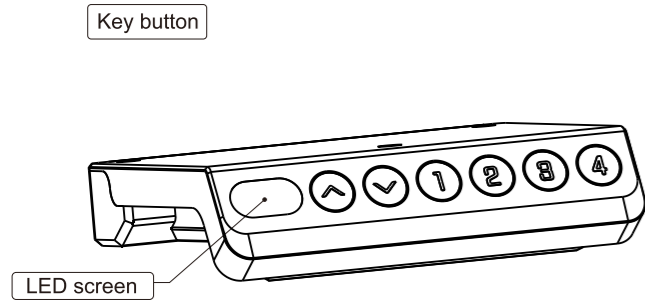

●	▲	Up button, adjust the desk upwards
●	▼	Down button, adjust the desk downwards
●	1	Position1, user's first stored height position
●	2	Position2, user's second stored height position
●	3	Position3, user's third stored height position
●	4	Position4, user's fourth stored height position

Operation Instruction

Adjust Height :

1. Long press the "^" or "v" button for continuous movement; press any button to stop.
2. Click the "^" or "v" button to fine-adjust height in increments of 0.1cm.

Memory Preset Height:

1. Adjust the desk to your desired height, then press and hold the "1" button for 5 seconds. A sound will play and the display will show "S-1", showing that the current height has been saved to slot 1. Simply press "1" to automatically adjust to that height again.
2. Repeat for presets "2" - "4" for up to four separate heights.

Reset Operation:

1. When the height of the device is incorrect or an error code appears, the device needs to be reset and corrected. Long press the button "3" and button "4" simultaneously for 5 seconds to enter this function.
2. After entering the reset function, the display shows "RST", long press the "v" button to reset the device. When the desktop descends to the lowest height, it will bounce upward and run until it is displayed "bot", that is, the reset is completed.

Adjust the Anti-Collision Sensitivity:

1. When the desk is in motion, it should rebound immediately when it encounters an obstacle. If this function is not working as intended, the sensitivity may have to be changed.
2. Long press the "^" and "v" buttons simultaneously for 5 seconds to cycle between four sensitivity settings: L-0, L-1, L-2, and L-3. (L-0=off; L-1=low sensitivity; L-2=medium sensitivity; L-3=high sensitivity.)

Operation Instruction

1. Reset: When the LED shows "RST" , press "▼" button until the desk reaches its lowest height and rebounds to stop, it means the reset has been finished.
2. If the desk will not work and the LED shows "E01" or "E02", please let the desk idle for at least 18 minutes before trying again.
3. If the "▼" button doesn't work, please check the cable connection and then cut off the power for at least 10 seconds. Reconnect to the power and press "▼" button to start the reset process when it shows the "RST".
4. If all these above process are inefficient, please contact our customer service.

Troubleshooting

This list is used for checking and solving common faults and errors. Please contact the manufacturer if problem you encounter is not on the list below.

Fault phenomenon	Method
No response while long pressing down arrow after connected with a power supply	Check if all the cables be connected well
No response while pressing up arrow / down arrow after connected with a power supply	Check if all the cables be connected well
Rising in a low speed	Check if overloaded, max loading: 110 lbs
The motor not move as instructed	Contact your supplier or dealer
Go down but not go up	Reposition
Downward sliding	Check if overloaded, max loading: 110 lbs
Frequently Reposition	Check if overloaded, max loading: 110 lbs
Overwork (Duty cycle:Max 2min on/18min OFF)	Restart after suspend for 18mins while connecting with power
Not enough up&down height	Press "3" and "4" together for 3 seconds or more, after hearing continuous beeping for twice, it will restore factory settings

Attention

- Power supply: AC100 - 240 V, frequency 50/60HZ;
- Working environment: 32° - 104° F;
- Before cleaning, you have to unplug the power supply cable. Clean with a slightly damp cloth to wipe away the surface dust. Keep all electrical components away from liquids. Do not damage the connection line and keep the plug in a safe position.
- Inside the control box, there are electronic components, metal parts, plastic parts, wires and so on. They should be disposed in accordance with the local laws and regulations. They cannot be disposed as household waste.
- Before using the product, please make sure the product has been installed correctly.
- Before starting use of the product, please read the instructions to fully understand all the product's functions and settings.
- Keep children away from electric height-adjustable desks, control units and handsets. Manufacturer is not responsible of any damages that result from children's unpredictable behaviour.
- Slight noise caused by the multi wedge belt or brake system will not impact the use of this product.
- Do not use corrosive or abrasive materials to clean this product and please dispose of cleaning solutions in an environmentally friendly manner.
- Understand the risks associated with using this product. Children or those with cognitive impairment should not use this product without supervision.
- Please operate in a clean and safe environment. For example, do not left around your tools. And always be careful to deal with packaging materials, in order to avoid any kinds of possible danger. Potential choking risk exists when children play with plastic bags!
- If necessary, retain the original package for future transportation.

Recycling and Disposal



This product cannot be disposed of as household waste. To prevent damage to the environment, this product should be recycled. Please use the relevant recycling systems available to you or contract the distributor or manufacturer for recycling assistance.

This limited warranty offered by FlexiSpot covers defects in material or workmanship in new FlexiSpot products. This warranty extends to the original purchaser only and is non-transferable. Only consumers purchasing FlexiSpot products from authorized FlexiSpot retailers or resellers may benefit from our limited warranty.

What is Covered?

The FlexiSpot limited warranty covers our products against defects in material or workmanship as follows:

•FlexiSpot Height Adjustable Desk Frames

All height-adjustable desks feature a 5-year warranty for the frame & motor and a 2-year warranty for the controller, switch, electronics and other mechanisms from the year of 2019.

•FlexiSpot Sit-Stand Desktop Workstations

All sit-stand desktop workstations feature a 5-year warranty for the frame and MDF desktop and 3-year warranty for the gas spring system and other mechanisms from the year of 2019.

•FlexiSpot Desk Bikes

All desk bikes and parts, including the frame, electronics, and other mechanisms, feature a 1-year warranty from the year of 2019.

•FlexiSpot Mini Steppers

All Mini Steppers feature a 3-year warranty from the year of 2019.

•FlexiSpot Monitor Mounts

All monitor mounts and parts, including arms, gas spring systems and other mechanisms, feature a 5-year warranty from the year of 2019.

What are your Remedies?

FlexiSpot will replace at no charge to the consumer the defective parts only or, at FlexiSpot's option, replace any product or part of the product that is defective because of improper workmanship and/or material, under normal installation, use, service and maintenance. If FlexiSpot is unable to provide a replacement and repair is not practical or cannot be completed in a timely fashion, FlexiSpot may elect to refund the purchase price in exchange for the return of the product. In the rare event that your FlexiSpot product is defective, we will provide you with a replacement item shipped at no cost to you within the continental United States. The shipping method for replacement products is FedEx Ground, but expedited shipping is available if you choose to pay the additional expense. In addition, you will need to pay the shipping costs if any products need to be shipped to you at an address outside the continental United States.

REPAIR OR REPLACEMENT (OR, IN LIMITED CIRCUMSTANCES, REFUND OF THE PURCHASE PRICE) AS PROVIDED UNDER THIS WARRANTY IS THE EXCLUSIVE REMEDY OF THE PURCHASER. FLEXISPOT NEITHER ASSUMES NOR AUTHORIZES ANY PERSON TO CREATE FOR ANY OTHER OBLIGATION OR LIABILITY IN CONNECTION WITH THIS PRODUCT.

What is Not Covered?

Our limited warranty does not cover any problem that is caused by:

1. Conditions, malfunctions or damage not resulting from defects in material or workmanship.
 2. Conditions, malfunctions or damage resulting from normal wear and tear, improper installation, improper maintenance, misuse, abuse, negligence, accident or alteration.
 3. Accessories, connected materials and products, or related products not manufactured by FlexiSpot.
 4. Conditions, malfunctions or damage resulting from failure to follow the instructions and guidelines relating to the product's intended use.
- Our limited warranty is void if a product is returned with removed, damaged or tampered labels or any alterations (including removal of any component or external cover).

How to File a Claim?

In order to receive the benefit of our limited warranty, you need to process your claim in compliance with the terms of this limited warranty and follow proper return procedure. To request warranty service, please contact customer service via email at contact@FlexiSpot.com or toll free at 855-421-2808. You will need to provide the sales receipt or other evidence of the date and place of purchase for your FlexiSpot product.

Implied Warranties and Limitation of Damages

EXCEPT TO THE EXTENT PROHIBITED BY APPLICABLE LAW, ALL IMPLIED WARRANTIES (INCLUDING WARRANTIES OF MERCHANTABILITY AND FITNESS FOR A PARTICULAR PURPOSE) SHALL BE LIMITED IN DURATION TO THE DURATION OF THIS WARRANTY, AND FLEXISPOT SHALL NOT BE LIABLE FOR ANY INCIDENTAL, INDIRECT, SPECIAL, OR CONSEQUENTIAL DAMAGES, INCLUDING BUT NOT LIMITED TO LOSS OF PROFITS OR REVENUE, RESULTING FROM ANY BREACH OF EXPRESS OR IMPLIED WARRANTY OR CONDITION, OR UNDER ANY OTHER LEGAL THEORY, EVEN IF FLEXISPOT HAS BEEN ADVISED OF THE POSSIBILITY OF SUCH DAMAGES. Some jurisdictions do not allow limitations on the duration of an implied warranty or the exclusion or limitation of special, indirect, incidental or consequential damages, so the above limitations or exclusions may not apply to you.

Governing Law

This Warranty shall be governed by the laws of the State of California, USA, without giving effect to any conflict of laws principles that may provide the application of the law of another jurisdiction.

How State Law Applies

This Warranty gives you specific legal rights, and you may also have other rights which vary from state to state.